

Alvicath

ENDOVASCULAR DIAGNOSTIC CATHETER

Alvicath is a diagnostic catheter for effective and fast endovascular diagnostic procedures.

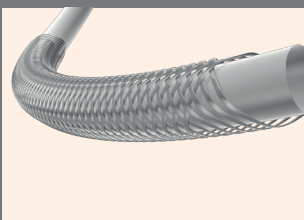

- Outstanding torque response and catheter stability due to Flat Wire Braid design
- Large inner lumens allow for superior visualization
- Wide choice of shapes to master every challenge

TECHNICAL DATA

Diameters:	4F, 5F, 6F & 7F	Braiding:	Stainless steel
Lengths:	45, 60, 65, 80 & 100 cm	Tip material:	Pebax
Shaft:	3 segments (variable stiffness)	Radiopaque component:	Barium Sulfate
Material main shaft:	Nylon	Maximum guidewire compatibility:	0.038"
Maximum Pressure	1200 psi		

DIMENSIONS

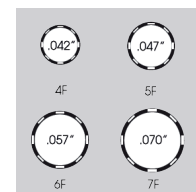

ORDER INFORMATION ALVICATH

	Diameter	Length	Catalog Number	Vertebral/ Multipurpose	Visceral/ Renal	Visceral/ Renal	Visceral/ Renal	Visceral/ Renal	Cerebral/ Visceral	Cerebral/ Visceral	Cerebral/ Visceral	Cerebral/ Visceral	
				Straight (STR)	Cobra 1 (C1)	Cobra 2 (C2)	Cobra 3 (C3)	Side Winder 1 (SIM1)	Side Winder 2 (SIM2)				
5 Pack	4 F	100	501110019650	100	501110019676	100	501110019677	100	501110019678	100	501110019660	100	501110019661
		80		80	501110201110	80	501110201112	80	501110201114				
		65		65	501110201109	65	501110201111	65	501110201113	65	501110201101	65	501110201103
	5 F	100	501110019750	100	501110019776	100	501110019777	100	501110019778	100	501110019760	100	501110019761
		80		80	501110201210	80	501110201212	80	501110201214				
		65		65	501110201209	65	501110201211	65	501110201213	65	501110201201	65	501110201203
	6 F	100	501110019850*	100	501110019876*	100	501110019877*	100	501110019878*	100	501110019860*	100	501110019861*
		80		80	501110201310*	80	501110201312*	80	501110201314*				
		65		65	501110201309*	65	501110201311*	65	501110201313*	65	501110201301*	65	501110201303*
	7 F	100	501110019950*	100	501110019976*	100	501110019977*	100	501110019978*	100	501110019960*	100	501110019961*
		80		80	501110201410*	80	501110201412*	80	501110201414*				
		65		65	501110201409*	65	501110201411*	65	501110201413*	65	501110201401*	65	501110201403*
10 Pack	4 F	100	501110188450	100	501110188476	100	501110188477	100	501110188478	100	501110188460	100	501110188461
		80		80	501110200610	80	501110200612	80	501110200614				
		65		65	501110200609	65	501110200611	65	501110200613	65	501110200601	65	501110200603
	5 F	100	501110188550	100	501110188576	100	501110188577	100	501110188578	100	501110188560	100	501110188561
		80		80	501110200810	80	501110200812	80	501110200814				
		65		65	501110200809	65	501110200811	65	501110200813	65	501110200801	65	501110200803
	6 F	100	501110188650*	100	501110188676*	100	501110188677*	100	501110188678*	100	501110188660*	100	501110188661*
		80		80	501110200910*	80	501110200912*	80	501110200914*				
		65		65	501110200909*	65	501110200911*	65	501110200913*	65	501110200901*	65	501110200903*
	7 F	100	501110188750*	100	501110188776*	100	501110188777*	100	501110188778*	100	501110188760*	100	501110188761*
		80		80	501110201010*	80	501110201012*	80	501110201014*				
		65		65	501110201009*	65	501110201011*	65	501110201013*	65	501110201001*	65	501110201003*

	Diameter	Length	Catalog Number	Cerebral	Cerebral	Cerebral	Cerebral	Vertebral/ Multipurpose	Visceral/ Renal				
				Head Hunter 1 (H1)	Head Hunter 1 Modified (H1H)	Head Hunter 3 (H3)	Head Hunter 3 Modified (H3H)	Vertebral (VER)	Rösch Inferior Mesenteric (RIM)				
5 Pack	4 F	100	501110019655	100	501110019658	100	501110019656	100	501110019659	100	501110019682	100	501110019681
	5 F	100	501110019755	100	501110019758	100	501110019756	100	501110019759	100	501110019782	100	501110019781
	6 F	100	501110019855*	100	501110019858*	100	501110019856*	100	501110019859*	100	501110019882*	100	501110019881*
	7 F	100	501110019955*	100	501110019958*	100	501110019956*	100	501110019959*	100	501110019982*	100	501110019981*
10 Pack	4 F	100	501110188455	100	501110188458	100	501110188456	100	501110188459	100	501110188482	100	501110188481
	5 F	100	501110188555	100	501110188558	100	501110188556	100	501110188559	100	501110188582	100	501110188581
	6 F	100	501110188655*	100	501110188658*	100	501110188656*	100	501110188659*	100	501110188682*	100	501110188681*
	7 F	100	501110188755*	100	501110188758*	100	501110188756*	100	501110188759*	100	501110188782*	100	501110188781*

*AVAILABLE ON REQUEST

ORDER INFORMATION ALVICATH (continued)

	Visceral / Renal		Visceral / Renal		Cerebral		Cerebral		Cerebral		Cerebral		
	J-Curve 1 (RC1)		J-Curve 2 (RC2)		Bentson 1 (JB1)		Mani (MAN)		Newton 3 (HN3)		Newton 4 (HN4)		
Diameter	Length	Catalog Number	Length	Catalog Number	Length	Catalog Number	Length	Catalog Number	Length	Catalog Number	Length	Catalog Number	
5 Pack	4 F	100	501110019679	100	501110019680	100	501110019669	100	501110019666	100	501110019664	100	501110019665
	5 F	100	501110019779	100	501110019780	100	501110019769	100	501110019766	100	501110019764	100	501110019765
	6 F	100	501110019879*	100	501110019880*	100	501110019869*	100	501110019866*	100	501110019864*	100	501110019865*
	7 F	100	501110019979*	100	501110019980*	100	501110019969*	100	501110019966*	100	501110019964*	100	501110019965*
	4 F	100	501110188479	100	501110188480	100	501110188469	100	501110188466	100	501110188464	100	501110188465
10 Pack	5 F	100	501110188579	100	501110188580	100	501110188569	100	501110188566	100	501110188564	100	501110188565
	6 F	100	501110188679*	100	501110188680*	100	501110188669*	100	501110188666*	100	501110188664*	100	501110188665*
	7 F	100	501110188779*	100	501110188780*	100	501110188769*	100	501110188766*	100	501110188764*	100	501110188765*

	Visceral / Renal		Visceral / Renal		Visceral / Renal		Visceral / Renal		Visceral / Renal		Visceral / Renal		
	Renal 55 (R55)		Renal 65 (R65)		Renal DC Right (RDC A1R)		Renal DC Left (RDC A1L)		Renal DC Right (RDC A2R)		Renal DC Left (RDC A2L)		
Diameter	Length	Catalog Number	Length	Catalog Number	Length	Catalog Number	Length	Catalog Number	Length	Catalog Number	Length	Catalog Number	
5 Pack	4 F	100	501110019646	100	501110019645	100	501110019672	100	501110019673	100	501110019674	100	501110019675
	5 F	100	501110019746	100	501110019745	65	501110201115	65	501110201116	65	501110201117	65	501110201118
						65	501110201215	65	501110201216	65	501110201217	65	501110201218
						65	501110019872*	100	501110019873*	100	501110019874*	100	501110019875*
	7 F	100	501110019946*	100	501110019945*	100	501110019972*	100	501110019973*	100	501110019974*	100	501110019975*
65						501110201415*	65	501110201416*	65	501110201417*	65	501110201418*	
10 Pack	4 F	100	501110188446	100	501110188445	100	501110188472	100	501110188473	100	501110188474	100	501110188475
	5 F	100	501110188546	100	501110188545	65	501110200615	65	501110200616	65	501110200617	65	501110200618
						100	501110188572	100	501110188573	100	501110188574	100	501110188575
	6 F	100	501110188646*	100	501110188645*	65	501110200815	65	501110200816	65	501110200817	65	501110200818
						65	501110188672*	100	501110188673*	100	501110188674*	100	501110188675*
7 F	100	501110188746*	100	501110188745*	100	501110188772*	100	501110188773*	100	501110188774*	100	501110188775*	
					65	501110201015*	65	501110201016*	65	501110201017*	65	501110201018*	

	Visceral / Renal		Visceral / Renal		Visceral / Renal		Uterine		Visceral / Renal		Visceral / Renal		Cerebral		
	Shepard Hook 0.8 (SHK 0.8)		Shepard Hook 1.0 (SHK 1.0)		Tennis Racket (TR)		BK		Chuang B (CHG B)		Chuang C (CHG C)		CK 1 (CK 1)		
Diameter	Length	Catalog Nr	Length	Catalog Nr	Length	Catalog Nr	Length	Catalog Nr	Length	Catalog Nr	Length	Catalog Nr	Length	Catalog Nr	
5 Pack	4 F	100	501110019671	100	501110019670	100	501110019654	100	501110019653	100	501110019683	100	501110019684	100	501110019685
	5 F	100	45	501110201105	45	501110201107									
			60	501110201106	60	501110201108									
			60	501110201205	45	501110201207									
	6 F	100	501110019871*	100	501110019870*	100	501110019854*	100	501110019853*	100	501110019883*	100	501110019884*	100	501110019885*
			45	501110201305*	45	501110201307*									
			60	501110201306*	60	501110201308*									
	7 F	100	501110019971*	100	501110019970*	100	501110019954*	100	501110019953*	100	501110019983*	100	501110019984*	100	501110019985*
			45	501110201405*	45	501110201407*									
60			501110201406*	60	501110201408*										
10 Pack	4 F	100	501110188471	100	501110188470	100	501110188454	100	501110188453	100	501110188483	100	501110188484	100	501110188485
	5 F	100	45	501110200605	45	501110200607									
			60	501110200606	60	501110200608									
			60	501110200805	45	501110200807									
	6 F	100	501110188671*	100	501110188670*	100	501110188654*	100	501110188653*	100	501110188683*	100	501110188684*	100	501110188685*
			45	501110200905*	45	501110200907*									
			60	501110200906*	60	501110200908*									
	7 F	100	501110188771*	100	501110188770*	100	501110188754*	100	501110188753*	100	501110188783*	100	501110188784*	100	501110188785*
			45	501110201005*	45	501110201007*									
60			501110201006*	60	501110201008*										

www.alvimedica.com

*AVAILABLE ON REQUEST

Please contact your local sales representative for product availability.

Not for sale in the USA and Japan.

The images shown within this document are of a purely illustrative nature and are not intended to depict reality.

Please consult product labels and package inserts for indications, contraindications, hazards, warnings, cautions and instruction for use.

©2014, Alvimedica. All Rights Reserved.



back to life!